

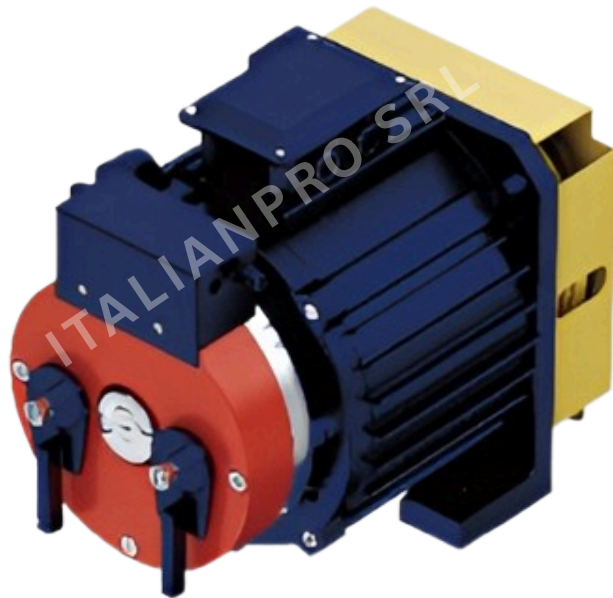

# ITALIANPRO

ELEVATOR GEARED-GEARLESS  
MACHINES & COMPONENTS

## PROI200 - 1 / PROI240 Series





# ITALIANPRO

## ELEVATOR GEARED-GEARLESS MACHINES & COMPONENTS

### Features

Load:320~800kg

Roping:2:1

Voltage:380V、 220V

IP Code:IP41

Brake Vol:DC110V

Speed:0.3~1.0m/s

Static Load:3000kg

INS.Class:F

Poles:16

Working System:S5-25%

### Overall Dimensions

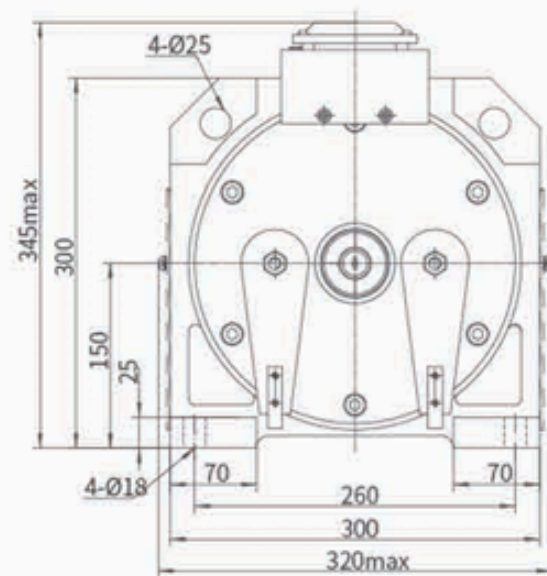
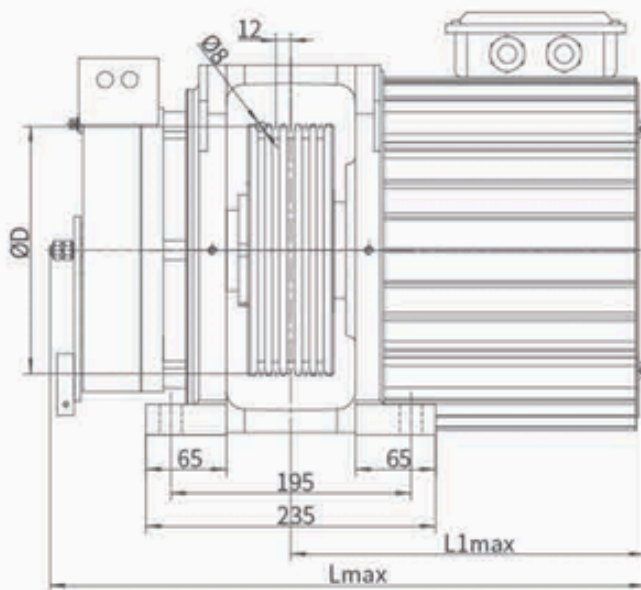

### Size Specification Table

| (Spec.)         | D (mm) | L (mm) | L1(mm) |
|-----------------|--------|--------|--------|
| PROS320         | 200    | 430    | 225    |
| PROS400/450     | 200    | 445    | 240    |
| PROS320/400/450 | 240    | 460    | 255    |
| PROS630         | 200    | 500    | 290    |
| PROS630         | 240    | 500    | 290    |
| PROS800         | 240    | 530    | 320    |



# ITALIANPRO

## ELEVATOR GEARED-GEARLESS MACHINES & COMPONENTS

### PROI200-1 Series Gearless Traction Machine Specification (Roping 2:1)

| Type    | Load (kg) | Speed (m/s) | Power (kW) | Current(A) 380V/220V | Speed (rpm) | Frequency (Hz) | Torque (N.m) | Sheave (mm) | Rope nxa-b | Brake current (A) | Net Weight (kg) |
|---------|-----------|-------------|------------|----------------------|-------------|----------------|--------------|-------------|------------|-------------------|-----------------|
| PROS320 | 320       | 0.3         | 0.7        | 3.4/5.8              | 57          | 7.6            | 110          | 200         | 3xØ8-12    | 1.5               | 70              |
|         | 320       | 0.4         | 0.9        | 3.4/5.8              | 76          | 10.1           | 110          | 200         | 3xØ8-12    | 1.5               | 70              |
|         | 320       | 0.5         | 1.1        | 3.8/6.5              | 96          | 12.8           | 110          | 200         | 3xØ8-12    | 1.5               | 70              |
|         | 320       | 0.63        | 1.3        | 3.8/6.5              | 120         | 16             | 110          | 200         | 3xØ8-12    | 1.5               | 70              |
|         | 320       | 1.0         | 2.2        | 5.3/9.2              | 191         | 25.5           | 110          | 200         | 3xØ8-12    | 1.5               | 70              |
| PROS400 | 400       | 0.3         | 0.9        | 4/6.9                | 57          | 7.6            | 135          | 200         | 3xØ8-12    | 1.5               | 75              |
|         | 400       | 0.4         | 1.1        | 4/6.9                | 76          | 10.1           | 135          | 200         | 3xØ8-12    | 1.5               | 75              |
|         | 400       | 0.5         | 1.3        | 4.5/7.8              | 96          | 12.8           | 135          | 200         | 3xØ8-12    | 1.5               | 75              |
|         | 400       | 0.63        | 1.7        | 4.5/7.8              | 120         | 16             | 135          | 200         | 3xØ8-12    | 1.5               | 75              |
|         | 400       | 1.0         | 2.7        | 6.2/10.8             | 191         | 25.5           | 135          | 200         | 3xØ8-12    | 1.5               | 75              |
| PROS450 | 450       | 0.4         | 1.3        | 4.5/7.8              | 76          | 10.1           | 150          | 200         | 4xØ8-12    | 1.5               | 75              |
|         | 450       | 0.5         | 1.6        | 5.1/8.8              | 96          | 12.8           | 150          | 200         | 4xØ8-12    | 1.5               | 75              |
|         | 450       | 0.63        | 1.9        | 5.1/8.8              | 120         | 16             | 150          | 200         | 4xØ8-12    | 1.5               | 75              |
|         | 450       | 1.0         | 3.2        | 6.9/12               | 191         | 25.5           | 150          | 200         | 4xØ8-12    | 1.5               | 75              |
| PROS630 | 630       | 0.4         | 1.7        | 6.5/11.3             | 76          | 10.1           | 210          | 200         | 5xØ8-12    | 1.75              | 130             |
|         | 630       | 0.5         | 2.1        | 6.5/11.3             | 96          | 12.8           | 210          | 200         | 5xØ8-12    | 1.75              | 130             |
|         | 630       | 0.63        | 2.7        | 6.5/11.3             | 120         | 16             | 210          | 200         | 5xØ8-12    | 1.75              | 130             |
|         | 630       | 1.0         | 4.2        | 9.5/16.5             | 191         | 25.5           | 210          | 200         | 5xØ8-12    | 1.75              | 130             |

### PROI240 Series Gearless Traction Machine Specification (Roping 2:1)

| Type    | Load (kg) | Speed (m/s) | Power (kW) | Current(A) 380V/220V | Speed (rpm) | Frequency (Hz) | Torque (N.m) | Sheave (mm) | Rope nxa-b | Brake current (A) | Net Weight (kg) |
|---------|-----------|-------------|------------|----------------------|-------------|----------------|--------------|-------------|------------|-------------------|-----------------|
| PROS320 | 320       | 0.3         | 0.7        | 3.6/6.2              | 48          | 6.4            | 130          | 240         | 3xØ8-12    | 1.5               | 85              |
|         | 320       | 0.4         | 0.9        | 3.6/6.2              | 64          | 8.5            | 130          | 240         | 3xØ8-12    | 1.5               | 85              |
|         | 320       | 0.5         | 1.1        | 4.3/7.5              | 80          | 10.7           | 130          | 240         | 3xØ8-12    | 1.5               | 85              |
|         | 320       | 0.63        | 1.3        | 4.3/7.5              | 100         | 13.3           | 130          | 240         | 3xØ8-12    | 1.5               | 85              |
|         | 320       | 1.0         | 2.2        | 5.7/9.9              | 159         | 21.2           | 130          | 240         | 3xØ8-12    | 1.5               | 85              |
| PROS400 | 400       | 0.3         | 0.9        | 4.5/7.8              | 48          | 6.4            | 160          | 240         | 3xØ8-12    | 1.5               | 85              |
|         | 400       | 0.4         | 1.1        | 4.5/7.8              | 64          | 8.5            | 160          | 240         | 3xØ8-12    | 1.5               | 85              |
|         | 400       | 0.5         | 1.3        | 5.5/9.6              | 80          | 10.7           | 160          | 240         | 3xØ8-12    | 1.5               | 85              |
|         | 400       | 0.63        | 1.7        | 5.5/9.6              | 100         | 13.3           | 160          | 240         | 3xØ8-12    | 1.5               | 85              |
|         | 400       | 1.0         | 2.7        | 7.2/12.4             | 159         | 21.2           | 160          | 240         | 3xØ8-12    | 1.5               | 85              |
| PROS450 | 450       | 0.4         | 1.3        | 5.1/8.8              | 64          | 8.5            | 180          | 240         | 4xØ8-12    | 1.5               | 85              |
|         | 450       | 0.5         | 1.6        | 6.2/10.8             | 80          | 10.7           | 180          | 240         | 4xØ8-12    | 1.5               | 85              |
|         | 450       | 0.63        | 1.9        | 6.2/10.8             | 100         | 13.3           | 180          | 240         | 4xØ8-12    | 1.5               | 85              |
|         | 450       | 1.0         | 3.2        | 8.1/14               | 159         | 21.2           | 180          | 240         | 4xØ8-12    | 1.5               | 85              |
| PROS630 | 630       | 0.4         | 1.7        | 7.8/13.6             | 64          | 8.5            | 250          | 240         | 5xØ8-12    | 1.75              | 135             |
|         | 630       | 0.5         | 2.1        | 7.8/13.6             | 80          | 10.7           | 250          | 240         | 5xØ8-12    | 1.75              | 135             |
|         | 630       | 0.63        | 2.7        | 7.8/13.6             | 100         | 13.3           | 250          | 240         | 5xØ8-12    | 1.75              | 135             |
|         | 630       | 1.0         | 4.2        | 11.5/19.8            | 159         | 21.2           | 250          | 240         | 5xØ8-12    | 1.75              | 135             |
| PROS800 | 800       | 0.5         | 2.7        | 8.1/14               | 80          | 10.7           | 320          | 240         | 6xØ8-12    | 1.75              | 155             |
|         | 800       | 0.63        | 3.4        | 8.1/14               | 100         | 13.3           | 320          | 240         | 6xØ8-12    | 1.75              | 155             |
|         | 800       | 1.0         | 5.3        | 12/20.8              | 159         | 21.2           | 320          | 240         | 6xØ8-12    | 1.75              | 155             |